

ITEM	QTY	DESCRIPTION	WIDTH	LENGTH	UM	PART NUMBER	MATERIAL	TYP
1	1	ASSEMBLY, COCKPIT			EA	COCKPIT-1		D
2	1	FRAME, MAIN			EA			D
3	1	ASSEMBLY, FRONT AXEL			EA	AXEL-1		D
4	4	ASSEMBLY, WHEEL			EA	WHEEL-1		D
5	1	ASSEMBLY, REAR AXEL			EA	AXEL-2		D
6	1	ROPE, STEERING		48.00	EA		1/4" NYLON	P
7	4	SCREWS, DRYWALL		2.5	EA		STEEL	P
8	REF	PART CUT DRAWING			EA	PARTS-1		D

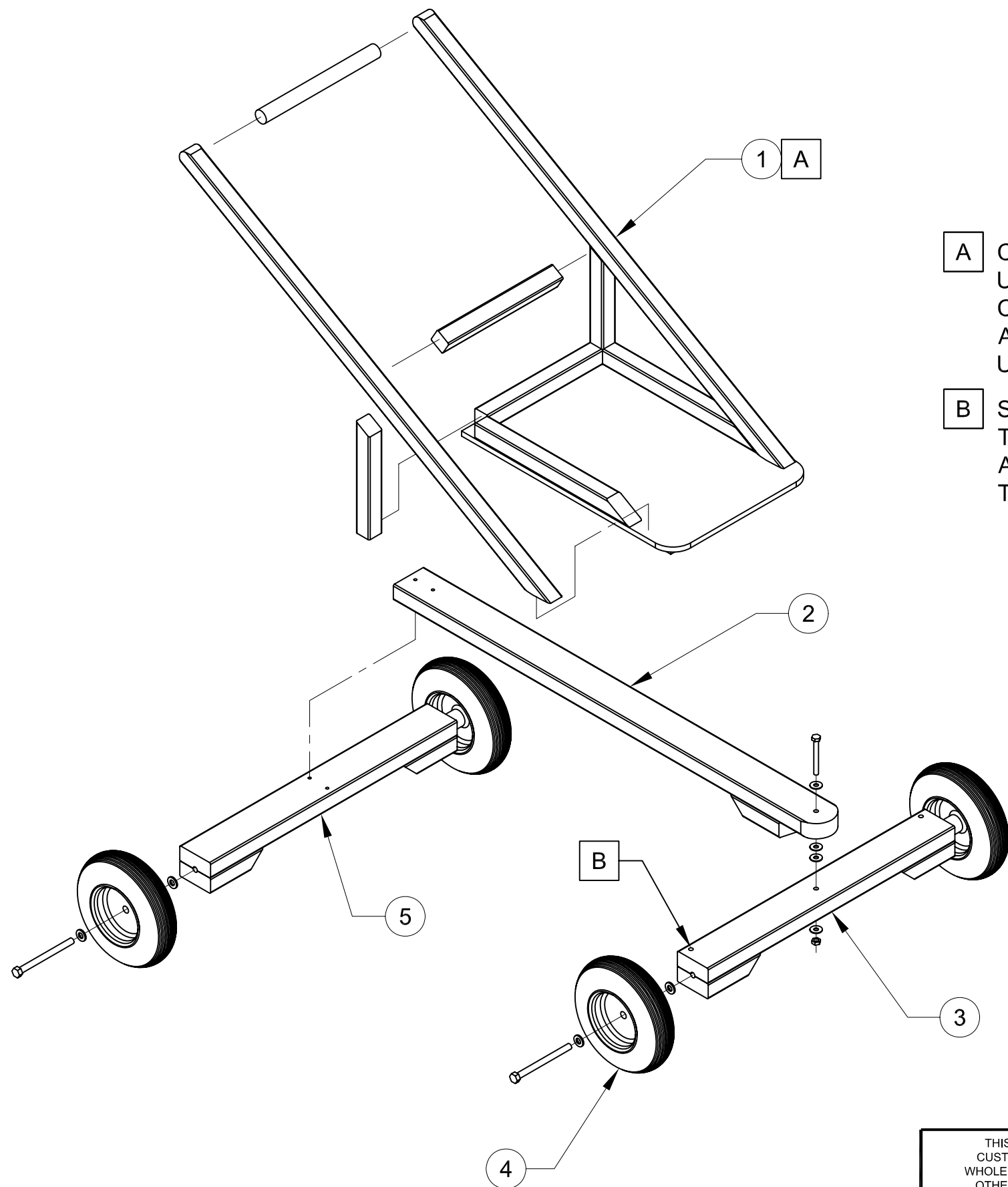

- A** COCKPIT IS TO BE FASTENED TO FRAME USING DRYWALL SCREWS. POSITION THE COCKPIT SO THAT THE SCOUT WILL BE ABLE TO CONTROL THE FRONT AXEL BY USING HIS FEET.
- B** STEERING ROPE IS TO BE THREADED THRU HOLES PROVIDED IN THE FRONT AXEL ASSEMBLY. FASTEN BY KNOTTING THE ENDS.

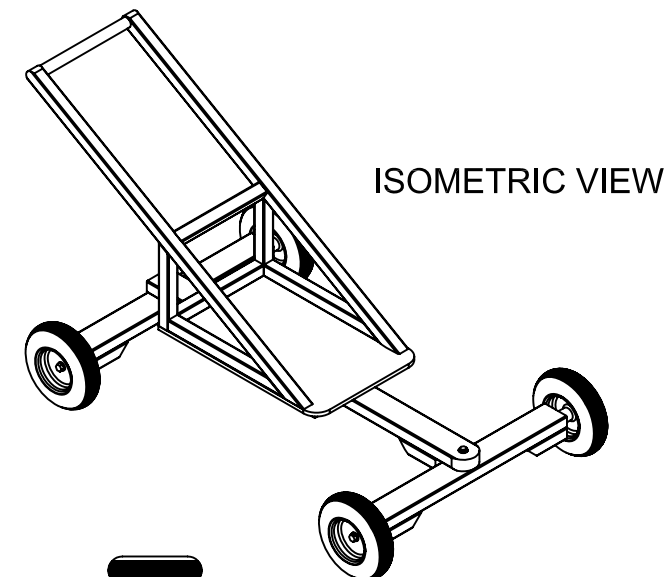

ISOMETRIC VIEW

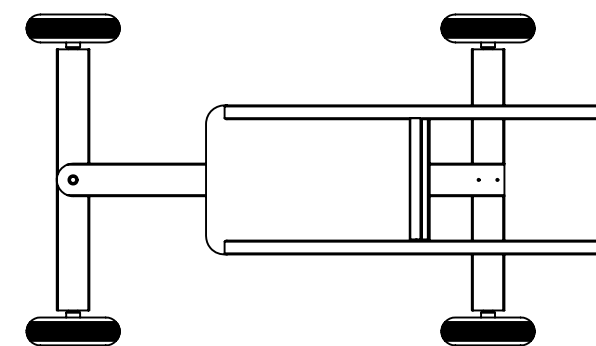

TOP VIEW

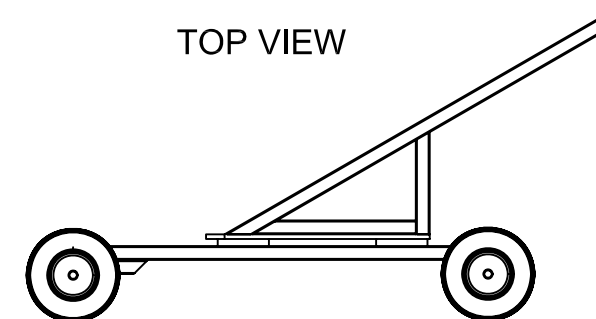

SIDE VIEW

THIS DRAWING IS THE PROPERTY THE CUSTOMER. IT SHALL NOT BE COPIED (IN WHOLE OR IN PART), FOR MANUFACTURE OR OTHERWISE DISCLOSED WITHOUT PRIOR WRITTEN CONSENT OF THE CUSTOMER.		TOLERANCES		SCALE: 1:2	TITLE: PACK 409 CUB-MOBILE ASSEMBLY, MAIN	
		MACHINING	FABRICATION	DRAWN BY: MGATES		
ESTIMATED WEIGHT:	FIRST ORDERED ON:	X. ±.040	ALL ±.06	DATE: 07JAN08	SIZE: A	SHEET 1 OF 1
		X.X ±.020	ANGULAR 2°	CHECKED BY:	REV	
		X.XX ±.010	ALL FINISHES 125mu	DATE:	DWG NO: ASSEMBLY	
		X.XXX ±.005	DEBURR ALL SHARP			
		ANGULAR ± 1/2°	CORNERS OR EDGES			