

ITEM	QTY	DESCRIPTION	WIDTH	LENGTH	UM	PART NUMBER	MATERIAL	TYP
1	1	ASSEMBLY, PADDLE			EA			D
2	2	BLOCK, BEARING			EA		PLASTIC	D
3	2	WOOD SCREW, NO.6		1.0	EA		STEEL	P
4	2	WASHER, PLAIN NO.6			EA		STEEL	P
5	2	WOOD SCREW, NO.6		.50	EA		STEEL	P
6	1	MOTOR (MOUSETRAP-MODIFIED)			EA			P
7	4	WOOD SCREW, NO.6		.75	EA		STEEL	P
8	4	WASHER, PLAIN NO.6			EA		STEEL	P
9	1	BEAM, MAIN			EA		WOOD	D
10	1	FLOAT, RIGHT			EA			D
11	1	FLOAT, LEFT			EA			D
12	1	STRING, DRIVE		12.0	EA		NYLON	P

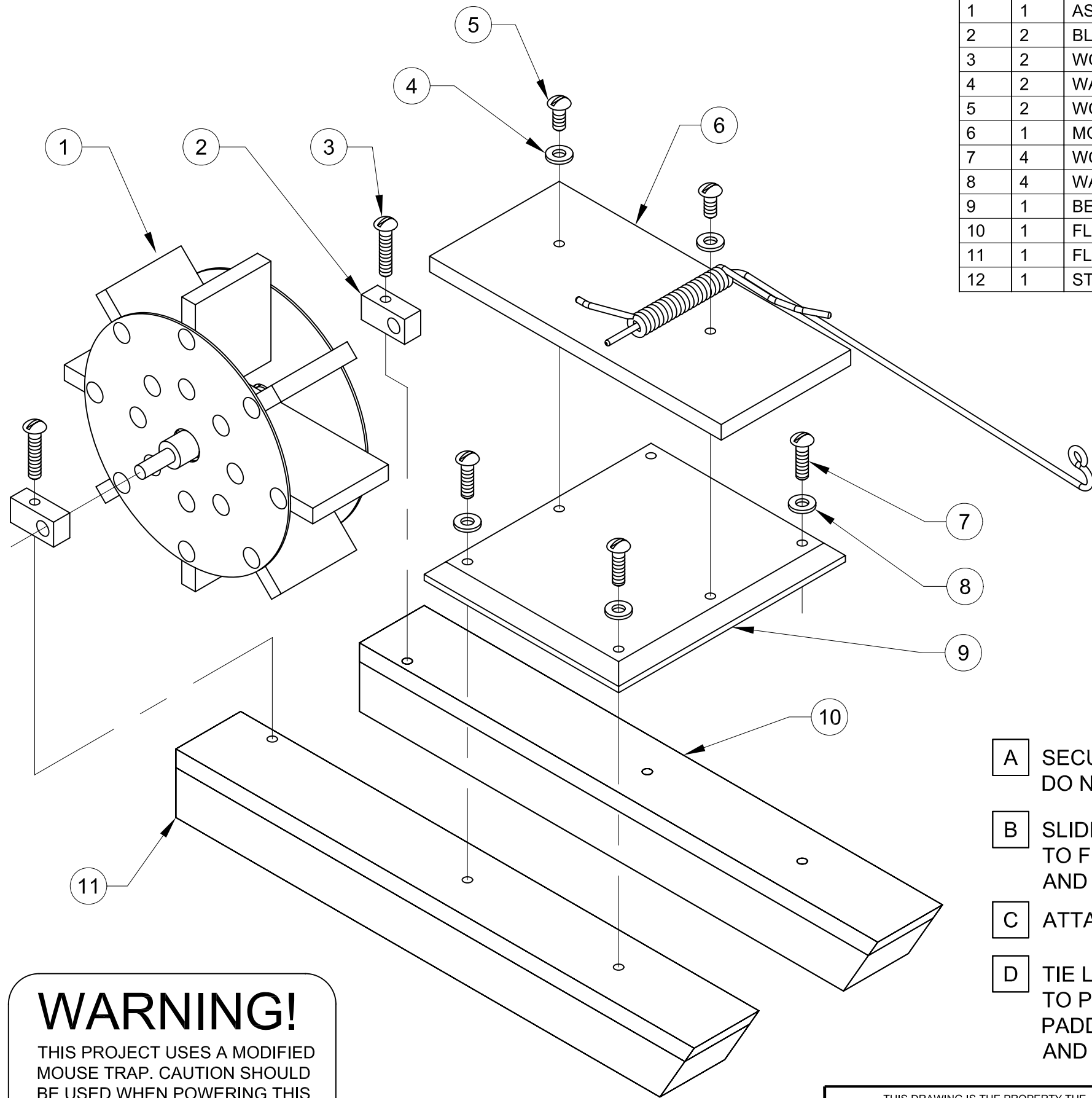

ISOMETRIC VIEW
(FOR REFERENCE ONLY)

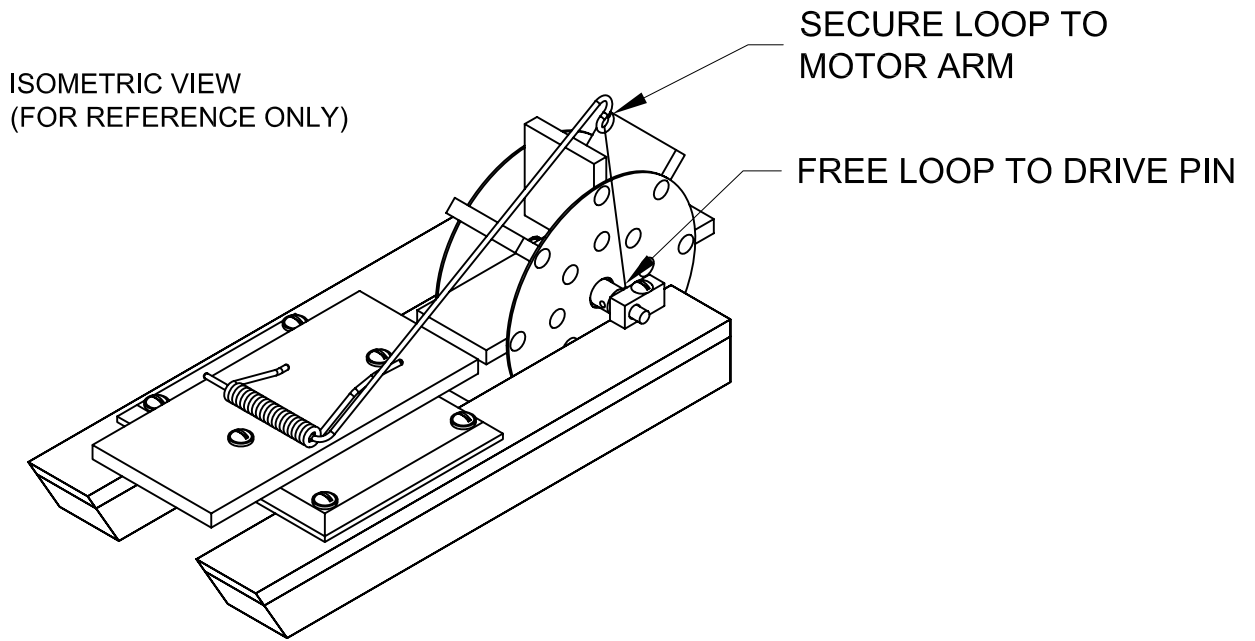

- A** SECURE THE MAIN BEAM (ITEM 9) TO THE LEFT/RIGHT FLOATS (ITEMS 10 & 11). DO NOT TIGHTEN SCREWS.
- B** SLIDE BUSHINGS (ITEM 2) ONTO THE PADDLE ASSEMBLY (ITEM 1) AND SECURE TO FLOATS WITH LONG SCREWS (ITEM 3). MAKE SURE THE PADDLE ASSEMBLY AND THE MAIN BEAM ARE STRAIGHT AND SQUARE... TIGHTEN ALL SCREWS.
- C** ATTACH THE MOTOR (ITEM 6) USING THE SHORT SCREWS (ITEM 5)
- D** TIE LOOPS IN EITHER END OF THE DRIVE STRING. ATTACH TO MOTOR ARM... TO POWER THE CRAFT, LOOP FREE END OF THE DRIVE STRING TO THE PADDLE DRIVE PIN AND WIND THE PADDLE ASSEMBLY. GO FIND SOME WATER AND LET IT RIP!

WARNING!

THIS PROJECT USES A MODIFIED MOUSE TRAP. CAUTION SHOULD BE USED WHEN POWERING THIS CRAFT. LITTLE FINGERS CAN BE INJURED. PLAY RESPONSIBLY.

THIS DRAWING IS THE PROPERTY OF THE CUSTOMER. IT SHALL NOT BE COPIED (IN WHOLE OR IN PART), FOR MANUFACTURE OR OTHERWISE DISCLOSED WITHOUT PRIOR WRITTEN CONSENT OF THE CUSTOMER.		TOLERANCES		SCALE: 1:1	TITLE: PACK 409- PROJECT MOUSE BOAT	
		MACHINING	FABRICATION	DRAWN BY: M GATES	DATE: 02NOV09	REV
ESTIMATED WEIGHT:	FIRST ORDERED ON:	X. ±.040	ALL ±.06	CHECKED BY:	SIZE: A	SHEET 1 OF 1
		X.X ±.020	ANGULAR 2°	DATE:	DWG NO: ASSEMBLY	
		X.XX ±.010	ALL FINISHES 125mu			
		X.XXX ±.005	DEBURR ALL SHARP CORNERS OR EDGES			
		ANGULAR ± 1/2°				