

ITEM	QTY	DESCRIPTION	WIDTH	LENGTH	UM	PART NUMBER	MATERIAL	TYP
1	1	WOODSCREW, FLAT HEAD #6		1.00	EA		STEEL	P
2	1	BASE, SPOOL			EA		WOOD	D
3	1	HANDLE			EA		WOOD	D
4	1	SPOOL, WIRE			EA		PLASTIC	D
5	1	WOODSCREW, FLATHEAD #6		1.00	EA		STEEL	P
6	1	PIVOT, SPOOL			EA		WOOD	D
7	1	WASHER, SPOOL			EA		WOOD	D
8	1	WASHER, STD FLAT #8			EA		STEEL	P
9	1	WOODSCREW, FLATHEAD #6		1.50	EA		STEEL	P
10	1	PLATE, CRANK			EA		WOOD	D
11	3	WASHER, STD FLAT #6			EA		STEEL	P
12	3	WOODSCREW, ROUND HEAD #6		.75	EA		STEEL	P
13	1	HANDLE, CRANK			EA		WOOD	D
14	1	SPEAKER, 3"			EA			P
15	3	WOODSCREW, ROUND HEAD #6		.375	EA		STEEL	P
16	1	SPEAKER, 2"			EA			P
17	1	ROD, SPEAKER HOLDING			EA		STEEL	D
18	1	WIRE, CAT5		50	FT		WIRE	P
19	1	HANDLE, SPEAKER			EA		WOOD	D
20	1	SPACER, SPOOL			EA		WOOD	D

HOLE IN SPOOL

E

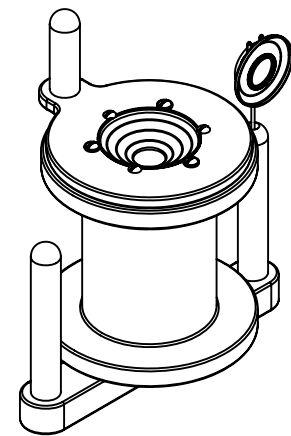

ISOMETRIC VIEW  
(FOR REFERENCE ONLY)

- A** ATTACH THE SPOOL (ITEM 4) TO THE BASE (ITEM 2) USING THE LONG WOODSCREW, WASHERS, PIVOT AND SPACER. (ITEMS 9,8,7,6,20)
- B** ATTACH THE HANDLE (ITEM 3) TO THE BASE (ITEM 2) USING SCREW (ITEM 1)
- C** ATTACH THE CRANK HANDLE (ITEM 13) TO CRANK PLATE (ITEM 10) USING WOODSCREW (ITEM 5)
- D** USING THE CRANK PLATE AS A TEMPLATE, DRILL PILOT HOLES INTO THE SPOOL AND ATTACH WITH SCREWS AND WASHERS. (ITEMS 11, 12)
- E** THREAD ONE END OF THE WIRE (ITEM 18) THRU THE HOLE IN THE SPOOL AND UP THRU THE CENTER. TIE AN OVERHAND KNOT 12" FROM THE END OF THE WIRE. SOLDER THE LEADS TO THE 3" SPEAKER (ITEM 14) AND ATTACH THE SPEAKER TO THE CRANK PLATE WITH SCREWS (ITEM 15).
- F** THREAD THE OTHER END OF THE WIRE (ITEM 18) THRU THE HOLE IN SPEAKER HANDLE (ITEM 19). TIE AN OVERHAND KNOT 2" FROM THE END. SLIDE THE SPEAKER HOLDING ROD THRU THE KNOT AND SOLDER THE LEADS TO THE 2" SPEAKER (ITEM 16). SLIDE THE SPEAKER HOLDING ROD AND WIRE INTO THE HANDLE. WIND THE WIRE ON TO THE SPOOL TO COMPLETE. OVER AND OUT.

THIS DRAWING IS THE PROPERTY THE CUSTOMER. IT SHALL NOT BE COPIED (IN WHOLE OR IN PART), FOR MANUFACTURE OR OTHERWISE DISCLOSED WITHOUT PRIOR WRITTEN CONSENT OF THE CUSTOMER.		TOLERANCES		SCALE: 1:1	TITLE: PACK 409- PROJECT ROGER WILCO	
		MACHINING	FABRICATION	DRAWN BY: M GATES		
ESTIMATED WEIGHT:	FIRST ORDERED ON:	X. ± .040	ALL ± .06	DATE: 16NOV09	SIZE: A SHEET 1 OF 1	REV
		X.X ± .020	ANGULAR 2°	CHECKED BY:		
		X.XX ± .010	ALL FINISHES 125mu	DATE:	DWG NO: ASSEMBLY	
		X.XXX ± .005	DEBURR ALL SHARP			
		ANGULAR ± 1/2°	CORNERS OR EDGES			